

NADA RESIDENCE

BUILDING DREAMS, ONE BRICK AT A TIME..



 **GADALLA**
— HOMES LTD —

LOCATED JUST
STEPS AWAY FROM

METROPOLIS MALL

OUR STORY

Building Dreams, One Brick at a Time



The Gadalla family's journey began in 2017 when they arrived in the heart of Cyprus—Larnaca City—with a vision to make a mark in the world of real estate. Armed with years of experience and deep roots in civil engineering, the Gadalla family didn't just want to build structures; they wanted to build homes, communities, and lasting legacies.

With a family of engineers at the helm, our approach to real estate development blends technical expertise with a passion for design. Every apartment and villa we create is more than just a living space—it's a modern sanctuary. We specialize in crafting luxurious, high-quality homes with contemporary designs that reflect the elegance and beauty of Cyprus itself.

At Gadalla, we understand that time is precious. That's why we're committed to delivering our projects on time, without ever compromising on the details. From groundbreaking to handover, our clients receive full support at every step. We believe in transparency, trust, and building relationships as strong as the foundations we lay.

For us, it's not just about construction—it's about creating spaces where life unfolds, and memories are made. Welcome to Gadalla, where precision engineering meets the art of luxury living.

At the core, We are a family

OUR PREVIOUS PROJECTS



MARIAM RESIDENCE
American Academy, City Center



JASMINE RESIDENCE
Spyrou Kyprianou (Sklavenitis), Larnaca



KAMARES VIEW 1 RESIDENCE
Kamares, Larnaca



HORREYA RESIDENCE
Chrysopolitissa, Larnaca



KAMARES VIEW 2 RESIDENCE
Kamares, Larnaca



LUJIANE RESIDENCE
Central Larnaca

PROJECT DESCRIPTION

NADA Residence offers an exceptional living experience in Larnaca, Cyprus, perfectly blending urban convenience with tranquil comfort. Located just a short walk from the vibrant Metropolis Mall, residents will enjoy easy access to shopping, dining, and entertainment, while still benefiting from a quiet and comfortable neighborhood atmosphere.

This exclusive development features a meticulously curated selection of homes, ***including four beautifully designed one-bedroom apartments and five spacious two-bedroom apartments***, catering to a variety of lifestyles. The building's architecture is a true highlight, boasting a thoughtfully crafted facade characterized by numerous setbacks and large, strategically placed windows.

This intelligent design not only enhances the building's aesthetic appeal but also ensures that every residence is flooded with incredible natural light, enjoys abundant fresh air, and offers captivating views, creating a bright and inviting living space.

PROJECT SITE



PROJECT LOCATION



12 MINS   LARNACA AIRPORT

3 MINS   METROPOLIS MALL

7 MINS   SEA

2 MINS   LARNACA HOSPITAL

5 MINS   SCHOOLS

7 MINS   CENTER OF LARNACA















GROUND FLOOR PLAN



ALL APARTMENTS INCLUDE
1 STORAGE AND ONE PARKING
SPOT ON THE GROUND FLOOR.

FIRST FLOOR PLAN



UNIT A101

BEDROOMS	1
INTERNAL AREA (M²)	53
COVERED BALCONIES (M2)	15

UNIT A102

BEDROOMS	1
INTERNAL AREA (M²)	51
COVERED BALCONIES (M2)	15

UNIT A103

BEDROOMS	1
INTERNAL AREA (M²)	52
COVERED BALCONIES (M2)	15

SECOND FLOOR PLAN



UNIT A201

BEDROOMS	2
INTERNAL AREA (M ²)	77
COVERED BALCONIES (M2)	20

UNIT A202

BEDROOMS	2
INTERNAL AREA (M ²)	78
COVERED BALCONIES (M2)	25

THIRD FLOOR PLAN



UNIT A301

BEDROOMS	2
INTERNAL AREA (M ²)	77
COVERED BALCONIES (M2)	20

UNIT A302

BEDROOMS	2
INTERNAL AREA (M ²)	78
COVERED BALCONIES (M2)	25

FOURTH FLOOR PLAN



UNIT A401

BEDROOMS	1
INTERNAL AREA (M ²)	69
COVERED BALCONIES (M2)	19
ROOF GARDEN (M2)	22

UNIT A402

BEDROOMS	1
INTERNAL AREA (M ²)	69
COVERED BALCONIES (M2)	21
UN COVERED BALCONIES (M2)	8
ROOF GARDEN (M2)	25

ROOF GARDEN PLAN

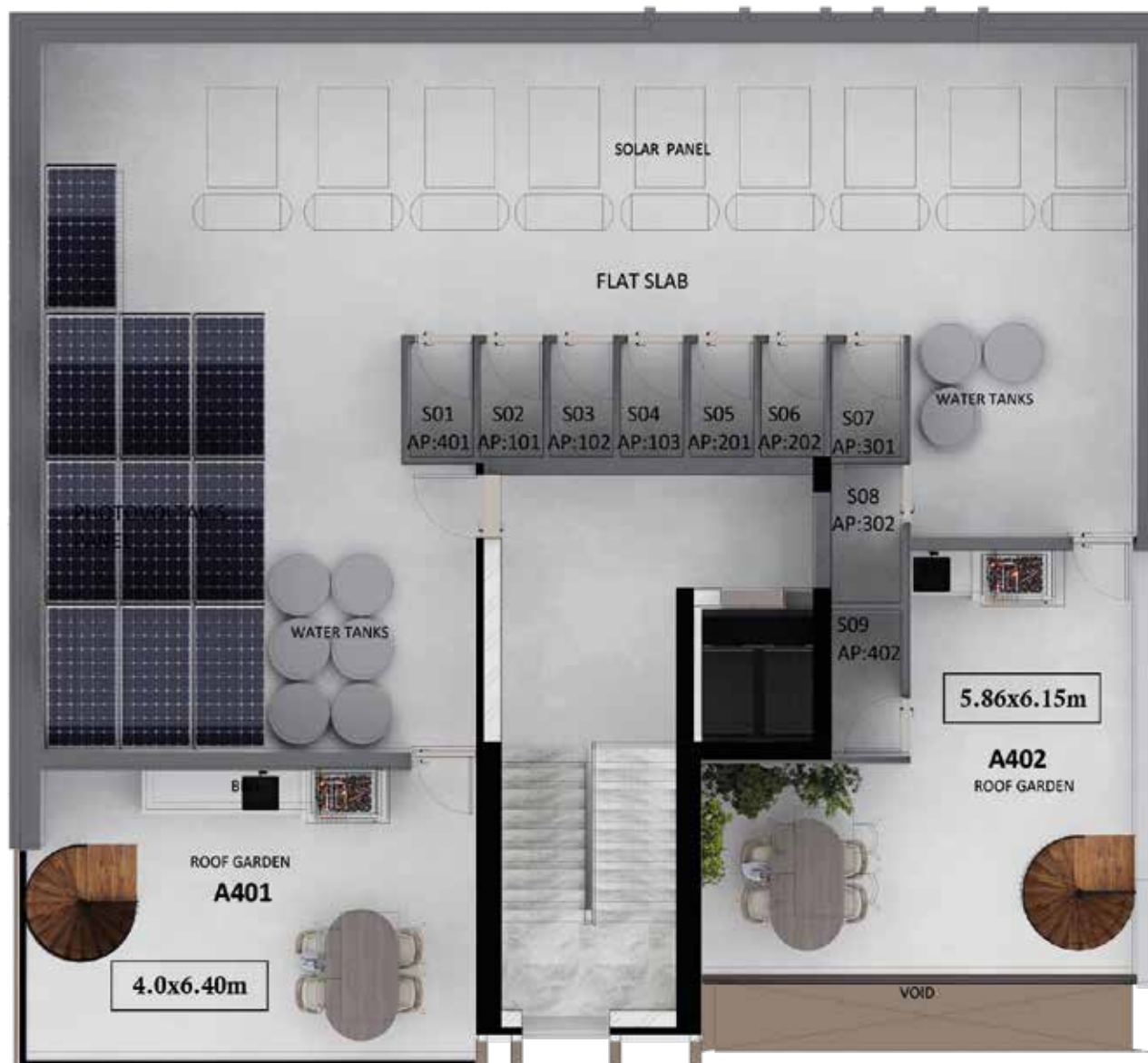



☎ 700-8888-6 📱 945-9999-0

✉ info@gadallahomes.com 🌐 www.gadallahomes.com

📍 28 Leontiou machaira street, shop no.101, Larnaca , 7102, Cyprus